



A-Class 2024

c-compactline | c-tourer | chic c-line | chic e-line | chic s-plus | liner-for-two

carthago[®]
Das Reisemobil.

TABLE OF CONTENTS

THE JOURNEY BEGINS

Carthago – More than just a company	4	5	Carthago City
The Carthago Premium DNA	6	8	Chassis selection
c-compactline Super-Lightweight	10	22	c-tourer Lightweight
c-tourer Comfort	30	42	chic c-line
chic e-line/s-plus	58	74	liner-for-two

THE DIGITAL CARTHAGO WORLD

ONLINE ON THE ROAD

Take the plunge into the digital world of Carthago! We have put together numerous items of additional information for you on our web site. Be it videos, 360° views or technical background information – experience now the digital world of fascinating Carthago motorhomes!

You can obtain a quick overview of our dealers using our online dealer search. You can find your nearest Carthago dealer with just a few mouse clicks – not only within Germany but also in neighbouring foreign countries. Our dealers will give you the opportunity to get to know our motorhomes better on site, and would be pleased to advise you.

Carthago is also active on social media. You will find many exciting articles featuring our vehicles and the Carthago brand on Facebook, and there are some great product videos packed with details on our YouTube channel. If you don't want to miss any of the news from Carthago, register now for our newsletter.

Simply scan the QR codes with the camera of your Smartphone or tablet, and you'll be taken straight to the topic of your choice.





The people behind the family-run company are: Sabrina Schuler, Karl-Heinz Schuler and Sebastian Schuler

CARTHAGO

MORE THAN JUST A COMPANY

More than 40 years of the Carthago Group also means more than 40 years of the premium concept, diversity and technical know-how. Many things have expanded during this time: our head office with production and a large sales showroom in Aulendorf in Upper Swabia, and our plants in Odranci/Slovenia and Ormož/Slovenia. The number of employees has also increased to more than 1500, and we have more than 200 dealers in Germany and abroad.

However, one thing hasn't changed: as well as using state-of-the-art manufacturing methods, each Carthago has been manufactured with care and a considerable amount of craftsmanship and attention to detail for more than 40 years. We have put our heart and soul into the development of the Carthago Group.

The only people we are indebted to are you, our customers. This independence was confirmed with the establishment of the Carthago family foundation in 2014, and will also remain so in the future. You can put your trust in this as much as our employees do: the Carthago Group remains a dynamic family-run company with a great deal of motivation and passion, characterised by personal commitment.

Yours, Karl-Heinz Schuler

Founder, owner and foundation chairman

CARTHAGO CITY

WELCOME

Down-to-earth and open minded at the same time, that is Carthago culture. We have remained true to our roots with the company headquarters in Carthago City in Aulendorf/ Upper Swabia, between Ulm and Lake Constance.

As well as the manufacturing facility for our premium motorhomes, a large sales showroom, the service centre and the company headquarters are concentrated here. Carthago is a popular destination for domestic and foreign motorhome enthusiasts. Visitors with a motorhome are welcome to use the company's own pitch!

You can discover numerous models in our large sales showroom during a visit – and the Carthago experts on

site would be pleased to advise you. Convince yourself of the combination of perfect craftsmanship with high-tech components and state-of-the-art manufacturing methods on a factory tour. Simply register your preferred date on our web site at www.carthago.com.

Of course, premium service is a constituent of the Carthago premium motorhome. More than 200 dealers and service partners throughout Europe will look after you and your Carthago motorhome. Wherever you live, wherever you roam: Carthago is never far away!



Carthago company headquarters in Aulendorf, Upper Swabia



State-of-the-art motorhome manufacturing

THE CARTHAGO PREMIUM DNA

MORE THAN A GOOD FEELING



Innovative thinking, an eye for detail, extravagant solutions and consistent development focus on a high degree of practical use, the perfect combination of high-tech lightweight construction materials, intelligent processing and pioneering spirit: these are the ingredients for our unique overall vehicle concept. They are deeply rooted in our Carthago Premium DNA.

It is an incentive and an obligation at the same time: the Carthago Premium DNA is our value promise to each Carthago customer, and brings together that which characterises every one of our motorhomes. And at the same time, it is an expression of that which makes Carthago different from other motorhomes. Our core expertise

is in motorhomes in the Liner premium class. Because our 40 years plus of experience flow into every stage of development and manufacturing. We think that only the best is good enough for your comfort and your safety! The materials and construction technologies which we use and the demands that are made of their weight and stability have much in common with aviation technology.

We can therefore offer you a high degree of durability, value retention, safety, protection and comfort, which makes every Carthago motorhome something special, and therefore synonymous with exclusivity and quality. Or, to put it simply, Carthago stands for “The Motorhome”.

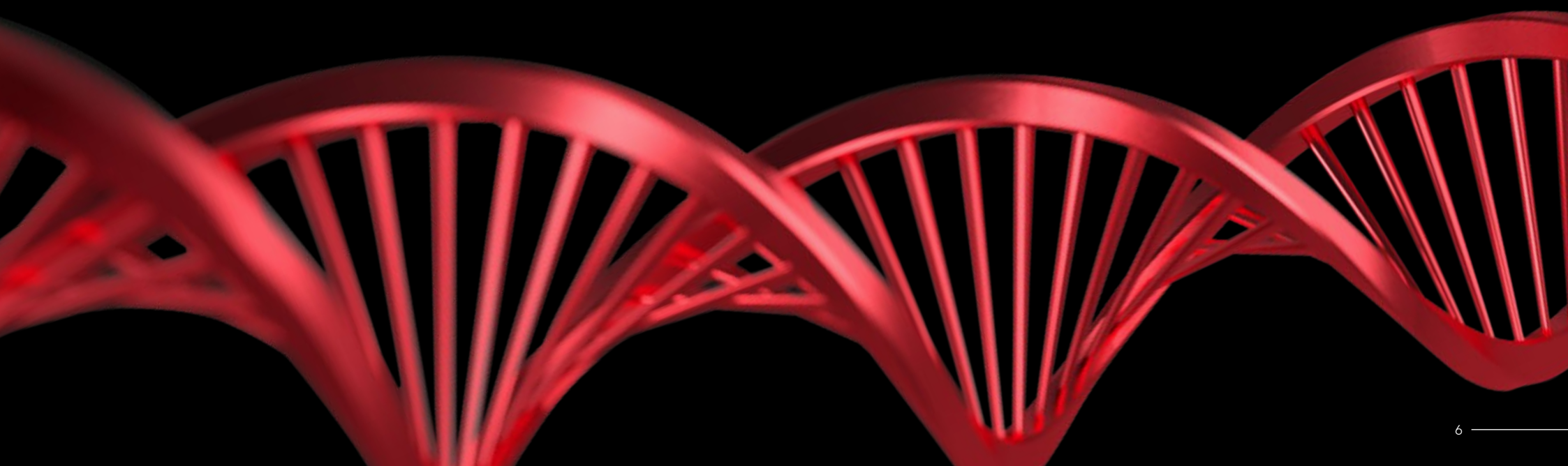

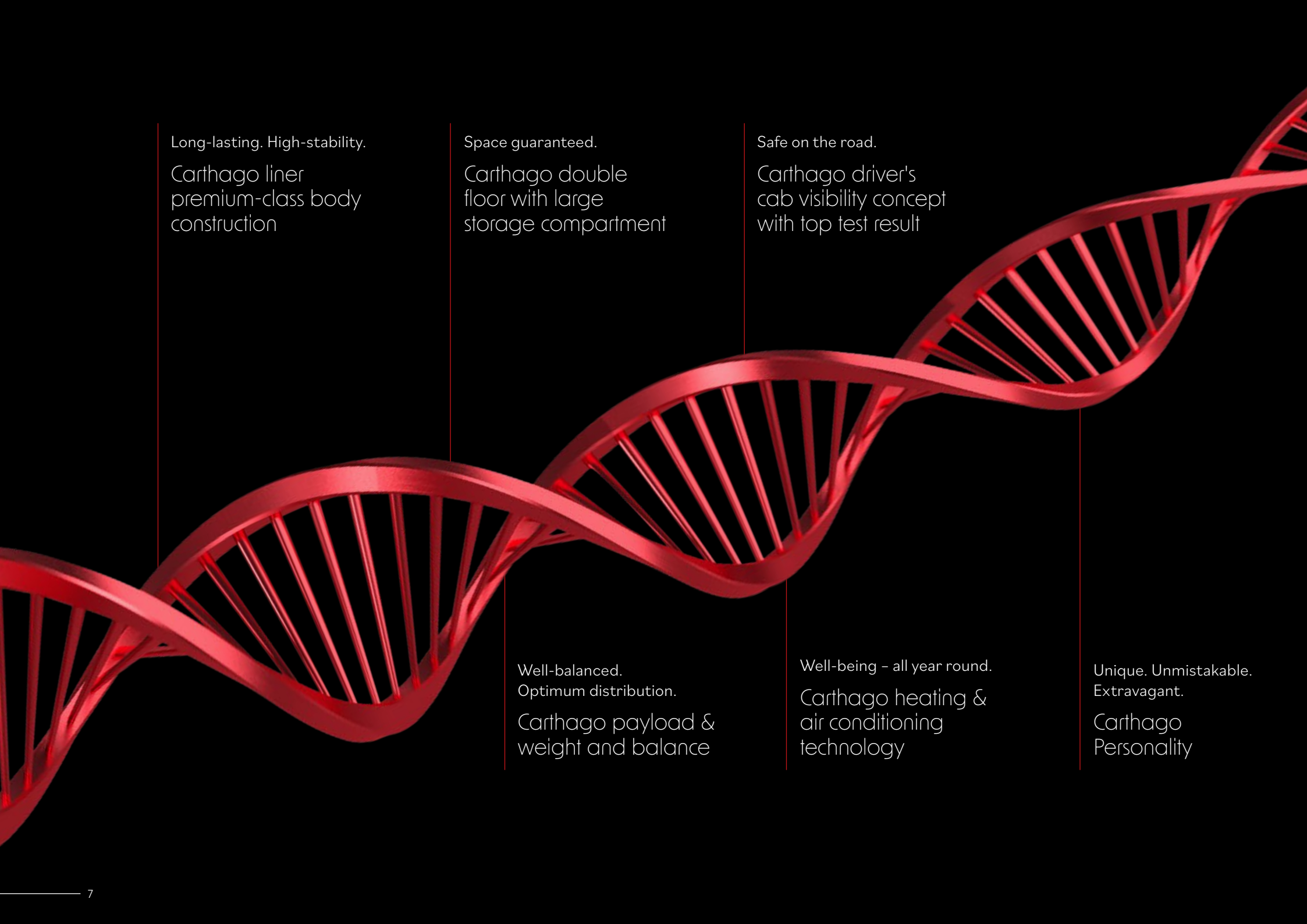

Long-lasting. High-stability.

Carthago liner
premium-class body
construction

Space guaranteed.

Carthago double
floor with large
storage compartment

Safe on the road.

Carthago driver's
cab visibility concept
with top test result

Well-balanced.
Optimum distribution.

Carthago payload &
weight and balance

Well-being – all year round.

Carthago heating &
air conditioning
technology

Unique. Unmistakable.
Extravagant.

Carthago
Personality

CHASSIS SELECTION



AL-KO
up to 4.8 t



AL-KO DA
up to 5.5 t



- ¹⁾ Optional: 16" alloy wheels for the Fiat Ducato f35 light chassis
- ²⁾ Optional: 16" alloy wheels for the Fiat Ducato f40 heavy Chassis / f35 light Chassis in conjunction with automatic transmission
- ³⁾ Optional: 16" special aluminium wheels for a weight increase to 4,800 kg (available for chic e-line single axle / liner-for-two single axle on Fiat Ducato)



Mercedes-Benz
AL-KO
up to 4.5 t



Mercedes-Benz
AL-KO DA
up to 5.5 t



- ⁴⁾ Optional: 16" aluminium wheels with year-round tyres for the Mercedes-Benz Sprinter chassis (standard in chic c-line superior models)



5.6 t / 6.7 t



- ⁵⁾ Optional: Aluminium wheels for the front axle for the Iveco Daily chassis, rear axle wheel trims visually adapted to the front axle alloy wheels

Fiat Ducato

Well-trying and comprehensively upgraded basic vehicle, light and extremely economical.

- + Light weight, front wheel drive
- + AL-KO low frame chassis with wide wheelbase
- + Powerful engines with a capacity of 2.2 l and output of up to 180 HP (132 kW) and torque of 450 Nm
- + Low emissions, emissions level Euro 6d Final
- + 9 gear ZF automatic transmission*
- + Electric power steering
- + Permissible gross weight of up to 4.8 t / 5.5 t as single or double axle vehicle
- + Numerous safety and assistance systems: Airbag, ESP, ABS, ASR, electronic immobiliser, Hillholder, Traction Plus, Hill Descent Control, automatic start/stop, cruise control, side wind assistant, stability control for trailer, collision braking system
- + Modern infotainment system (including digital instrument cluster with colour display, 10.1" multimedia system including navigation and motorhome route guide)*
- + Optional for the c-compactline Super-Lightweight, c-tourer Lightweight, c-tourer Comfort, chic c-line, chic e-line and liner-for-two model ranges

Mercedes-Benz Sprinter

Technically innovative basic vehicle with outstanding comfort.

- + Front wheel drive
- + AL-KO low frame chassis with wide wheelbase
- + Powerful engines with a capacity of 2.0 l and output of up to 170 HP (125 kW) and torque of 400 Nm
- + Low emissions, emissions level Euro VI E
- + 9G-TRONIC automatic transmission*
- + Fuel-saving electro-hydraulic steering, practical electric parking brake
- + Comfortably equipped cab
- + Permissible gross weight of up to 4.5 t / 5.5 t as single or double axle vehicle
- + Numerous safety and assistance systems: Airbag, side wind assistant, Hillholder, ABS, ASR, EBV, ESP, DISTRONIC distance assistant*, braking assistant*, alertness assistant*, tyre inflation pressure monitoring system* | **
- + MBUX infotainment system (Mercedes-Benz User Experience)*
- + Optional for the c-tourer Lightweight, c-tourer Comfort, chic c-line and chic e-line model ranges

Iveco Daily

The heavy load specialist, extremely robust and load-bearing.

- + Extremely strong and robust ladder-type high frame
- + High traction rear wheel drive, dual wheels
- + High towed load of up to 3,500 kg
- + Extremely powerful engines with a maximum capacity of 3.0 l and output of up to 207 HP (152 kW) and torque of 470 Nm
- + Low emissions, emissions level Euro VI E
- + 8 gear ZF automatic transmission*
- + Fuel-saving electro-hydraulic steering, practical electric parking brake
- + Permissible gross weight of up to 6.7 t
- + Iveco assistance systems: ESP, ASR, ABS, electronic immobiliser, Hillholder, emergency braking assistant*, distance control cruise control*, main beam activation*, lane departure assistant*, tyre pressure sensors*, rain sensor* | **
- + Optional for the chic s-plus and liner-for-two model ranges



Info



360°

c-compactline

Super-Lightweight



THE LIGHTEST MOTORHOME
OF THE CARTHAGO A-CLASS
3.5 T PREMIUM CLASS

Suitable for remote areas thanks to
the 15 cm narrower exterior width
and the compact vehicle lengths



I 138 DB | I 141 LE | I 143 LE



AL-KO



Further and detailed information can be found online at www.carthago.com

THE C-COMPACTLINE

BEING LIGHTWEIGHT DOESN'T MEAN MISSING OUT

The c-compactline Super-Lightweight sets the standard in the Carthago 3.5 t weight class. Its 15 cm narrower exterior width and compact vehicle lengths make it particularly suitable for remote areas. However, with Carthago, being light certainly doesn't mean missing out. The vehicle impresses with its outstanding quality and comfort. Thanks to the Carthago lightweight construction technology, the c-compactline also provides a reserves in the 3.5 t weight class. The "smartline" furniture design adapts perfectly to the narrow width of the vehicle, and

impresses with maximum living comfort and more freedom of movement. With an L-shaped lounge seating area, a practical galley kitchen, a space-saving bathroom and extra-large beds, every layout is optimally and practically equipped. The double floor provides additional storage space which is conveniently accessible from the outside and also from the inside. Thanks to having the choice of two different worlds of style, three layouts and numerous worlds of living, you can configure your c-compactline completely in accordance with your taste.



All models also available with permissible gross weight of 3,500 kg



Gross weight of up to 4.25 t possible*



Outstanding living comfort with lots of freedom of movement

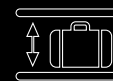

Unique double floor with large storage compartment



Large fresh and waste water reserves (150 l / 140 l)



Truma Combi 6 warm air storage heating technology

epic world of style as standard



Optional casablanca world of style





I 141 LE



I 141 LE



I 141 LE



I 141 LE

LIVING | KITCHEN

- 1** L-shaped lounge seating area with lift-up side seat bench / pull-out side seat and 360° living area table
- 2** Swivel-out shoe cabinet with holding system for up to four pairs of shoes
- 3** Space-saving galley kitchen with six large drawers, separate waste bin in separate hygiene area and designer overhead storage compartment with vertical waveform
- 4** 133 | Slimtower fridge with door that opens at both sides and separate freezer compartment



BATHROOM

- 1 Vario swivelling bathroom with large, completely separable shower room thanks to the interior swivelling wall and sectional shower door, large mirror with backlighting and additional cabinet with shelving arrangement and shelves | I 141 LE
- 2 Combination bathroom with spacious round shower that is completely separable using a sliding door, mirrored storage cabinet and spacious wash table base unit | I 138 DB, I 143 LE





CHANGING ROOM

- 1 Private changing room with partitioning from living/sleeping area | I 141 LE, I 143 LE



SLEEPING

- 1** Large transverse double bed with extra-large sleeping area and comfortable bed access via large entrance step | I 138 DB
- 2** Large wardrobe beneath bed, with flexibly extendible wardrobe depth in direction of scooter garage | I 138 DB
- 3** Lengthways single beds with extra-large sleeping areas and convenient access to the bed thanks to the access steps | I 141 LE, I 143 LE
- 4** Wardrobes with large interior height beneath lengthways single beds, conveniently accessible from the front and above via the lift function | I 141 LE, I 143 LE

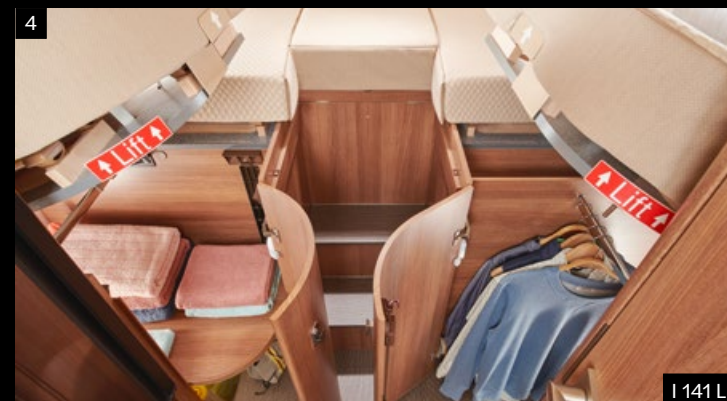
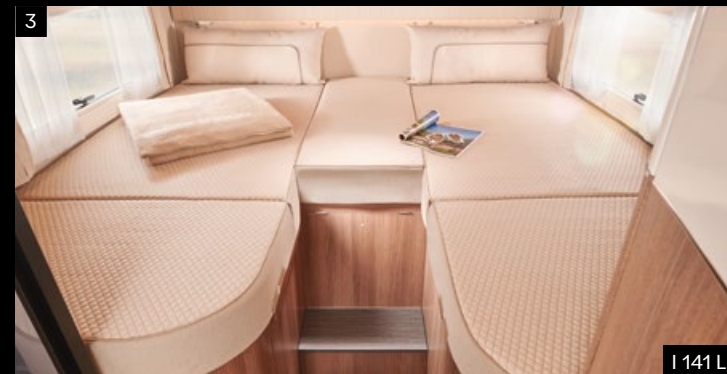

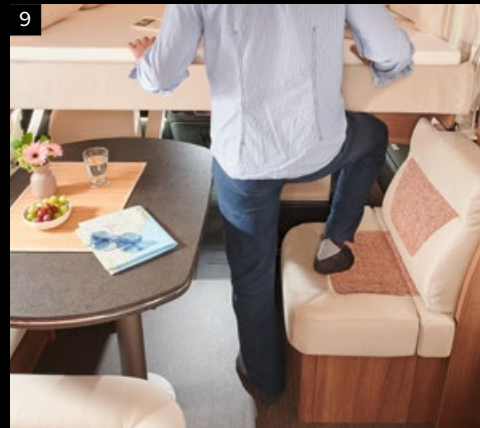
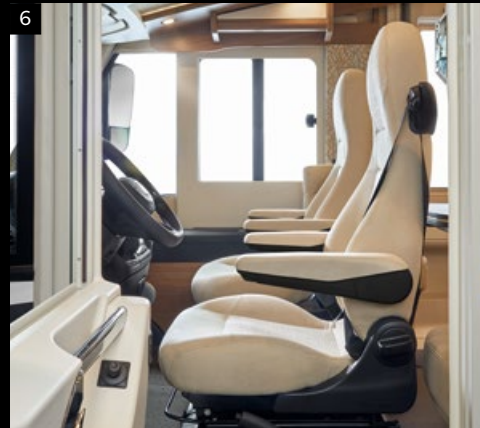
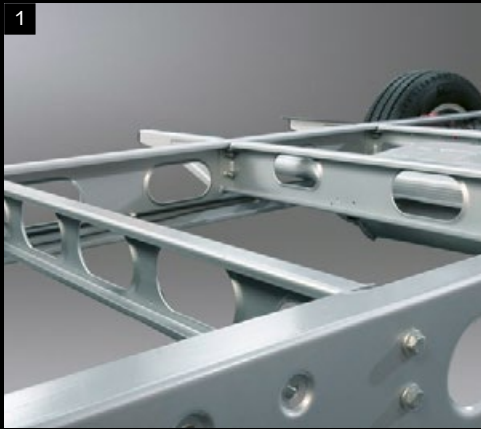



STANDARD EQUIPMENT

- 1** AL-KO low frame Carthago special with light weight and passenger car-like driving comfort
- 2** XL habitation door “premium two 2.0” with widened 63 cm passage, secure double locking, extra-wide door window, pleated blackout blind and integrated insect screen roller blind
- 3** Convenient access to the garage at both sides thanks to two large scooter garage doors at the driver and passenger sides
- 4** Exterior hatches and doors with interior hinges – integrated flush in the body
- 5** With horizontally operated insulated pleated wind-screen blind, multifunctional and therefore acts as a sunblind, privacy screen and blackout blind with insulation at the same time
- 6** Aguti driver’s cabin pilot seat with upholstered arm-rests, outstanding seat comfort and multiple adjusting facilities
- 7** Elegant dashboard with practical sideboard and preparation for integrated reversing camera monitor and drinks bottle holder
- 8** Innovative light concept with ambient lighting
- 9** Side seat bench as a comfortable footrest in the TV position or also as a climbing aid for accessing the drop-down bed

LAYOUTS

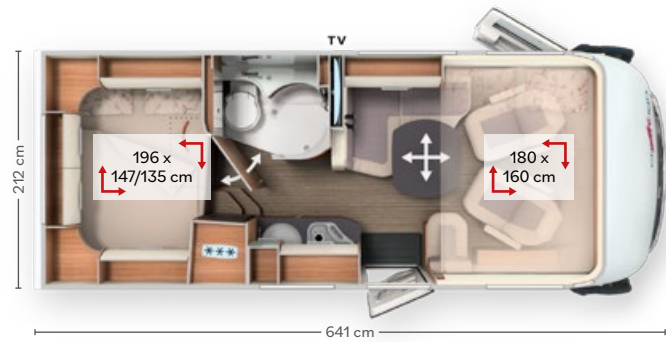

c-compactline Super-Lightweight I 138 DB



Layout with short vehicle length, targeted at the 3.5 t weight class

- + Gross weight up to 4.25 t*
- + L-shaped lounge seating area with lift-up side seat bench and 360° living area table
- + Compact galley kitchen with six large drawers and separate waste bin in separate hygiene area
- + Space-saving combination bathroom
- + Large transverse double bed with entrance step
- + Wardrobe beneath the transverse rear bed, depth individually adjustable in the direction of the scooter garage
- + Scooter garage with extra-large interior height

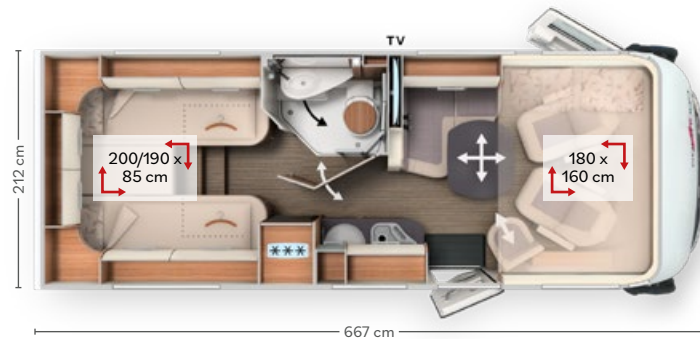

c-compactline Super-Lightweight I 141 LE



Innovative layout with short vehicle length, targeted at the 3.5 t weight class

- + Gross weight up to 4.25 t*
- + L-shaped lounge seating area with pull-out side seat and 360° living area table
- + Compact galley kitchen with six large drawers and separate waste bin in separate hygiene area
- + Space-saving Vario swivelling bathroom with separable changing room
- + Large lengthways single beds with access steps
- + Wardrobes with extra-large interior height beneath the lengthways single beds
- + Scooter garage with extra-large interior height

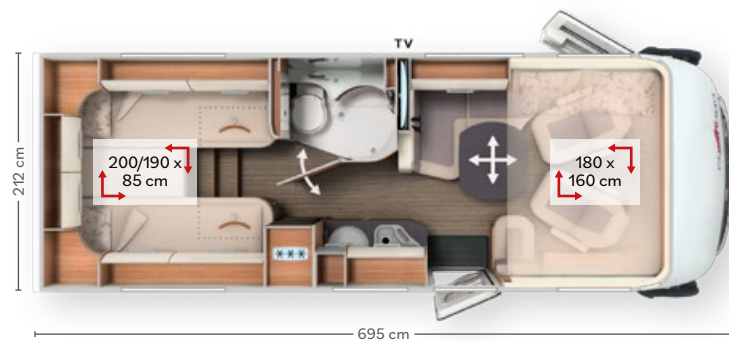

c-compactline Super-Lightweight I 143 LE



All-rounder: lots of comfort, short vehicle length, light weight

- + Gross weight up to 4.25 t*
- + L-shaped lounge seating area with lift-up side seat bench and 360° living area table
- + Compact galley kitchen with six large drawers and separate waste bin in separate hygiene area
- + Space-saving combined bathroom with separable changing room
- + Large lengthways single beds with access steps
- + Wardrobes with extra-large interior height beneath the lengthways single beds
- + Scooter garage with extra-large interior height



CARTHAGO LIGHTWEIGHT CONSTRUCTION TECHNOLOGY



DOWN WITH THE WEIGHT, UP WITH THE QUALITY

Extremely stable and super-light: Carthago is the pioneer for intelligent lightweight construction throughout the industry: Carthago reduces the weight, but not the customary comfort, stability or quality. The consistent lightweight construction technology has many benefits: more payload, lower fuel

consumption and fewer emissions at the same time. For the first time, Carthago has succeeded in developing a premium motorhome in the 3.5 t weight class in a practicable way, since when it has been the benchmark in the premium class.

PRACTICAL EQUIPMENT



Premium bodywork with aluminium frame members bonded over their entire surface and roof rounding



High-stability wall structure thanks to aluminium/aluminium sandwich and RTM hard foam insulation



Double floor, fully heated, with underfloor heating effect



Double floor with huge, heated storage compartment, scooter garage with interior height of up to 120 cm with extra-low rear, loadable up to 350 kg



Single level living area floor and large L-shaped lounge seating area



133 l Slimtower fridge at hand height with door that opens at both sides



Vario swivelling bathroom or combined bathroom with separable round shower and changing room



Extra-large sleeping area, fixed beds with 7-zone quality cold foam mattress and sprung slatted frame with flexibly supported wooden slats

YOUR ADDED VALUE

- + Outstanding manoeuvrability and less weight due to short vehicle lengths
- + More payload, also in the 3.5 t weight class
- + Lower fuel consumption

- + Class B driver's license sufficient
- + Fewer restrictions because of road traffic regulations
- + Fewer toll charges



c-tourer

Lightweight

THE SOPHISTICATED
ALL-ROUNDER

Short vehicle lengths, perfect
handling and light weight

I 141 LE | I 143 LE | I 145 RB LE



AL-KO



Mercedes-Benz

AL-KO



Further and detailed information can be found online at www.carthago.com

THE C-TOURER LIGHTWEIGHT

SURPASSES EVERY REQUIREMENT

The c-tourer Lightweight models provide maximum living comfort thanks to the “smartline plus” furniture design, the continuous living room floor, the comfortable L-shaped lounge seating area and the extra-large beds with a sleeping length of up to 200 cm. The high-quality kitchen and the extremely practical bathroom round off the interior perfectly. Thanks to our intelligent storage compartment solutions with a large double floor, large

central through-loading compartment and extra-large scooter garage, you don't have to forego anything when it comes to luggage. You have the choice between two basic vehicles, two worlds of style, numerous worlds of living and three layouts. The c-tourer Lightweight models offer a wide variety of ways of configuring your new motorhome completely in accordance with your individual requirements.



Selected models also available with permissible gross weight of 3,500 kg



Gross weight of up to 4.5 t possible*



Outstanding living comfort and a habitation width of 2.27 m

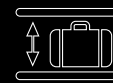

Unique double floor with large storage compartment



Large fresh and waste water reserves (150 l / 140 l)



Truma Combi 6 warm air storage heating technology

epic world of style as standard



Optional casablanca world of style





I 145 RB LE



I 145 RB LE



I 141 LE



I 145 RB LE

LIVING | KITCHEN

- 1 L-shaped lounge seating area with lift-up side seat bench/pull-out side seat and 360° living area table
- 2 Swing-out shoe cabinet with holding system for up to four pairs of shoes
- 3 Space-saving galley kitchen with six large drawers, separate waste bin in separate hygiene area and designer overhead storage cabinet with vertical waveform | I 141 LE, I 143 LE
- 4 Comfort corner kitchen with large, curved work surface, six large drawers, separate waste bin in separate hygiene area, designer overhead storage cabinet with vertical waveform and elevated kitchen worktop for visual room partitioning and as an additional work surface | I 145 RB LE



BATHROOM

- 1 Vario swivelling bathroom with large, completely separable shower room thanks to internal swivelling wall and sectional shower door | I 141 LE
- 2 Combination bathroom with spacious round shower that is completely separable via a sliding door and a mirrored storage cabinet | I 143 LE
- 3 Comfort luxury bathroom with spacious washing and toilet room with spacious mirrored and wash table base unit and shower opposite with waterproof shower insert with same design as living area floor | I 145 RB LE





I 141 LE



I 143 LE

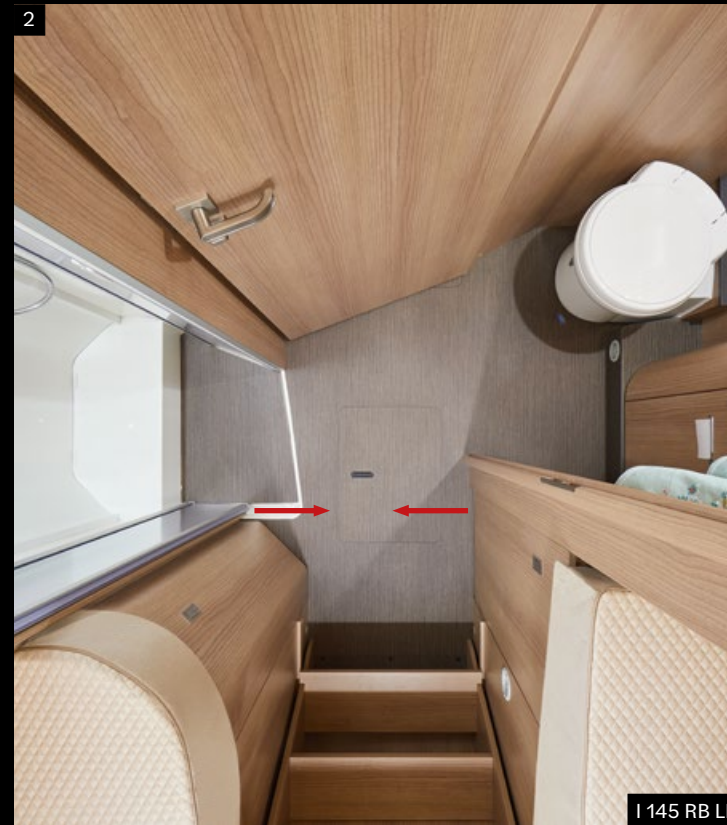

I 145 RB LE

CHANGING ROOM

1 Private changing room with partitioning from living and sleeping area | I 141 LE, I 143 LE

2 Private changing room with partitioning from living and sleeping area; the solid wood sliding door in the sleeping area* provides further room partitioning and therefore a completely separate changing room | I 145 RB LE



SLEEPING

- 1 Lengthways single beds with extra-large sleeping areas and adjustable head sections | I 141 LE, I 143 LE, I 145 RB LE
- 2 Convenient access to bed thanks to pull-out lightweight access steps | I 141 LE, I 143 LE, I 145 RB LE*
- 3 Wardrobes with large interior height beneath lengthways single beds, conveniently accessible from front and above via the lift function | I 141 LE, I 143 LE, I 145 RB LE





c-tourer

Comfort

THE SOPHISTICATED ALL-ROUNDER

Sporty, distinctive and cosy at the same
time. Perfect for vehicles over 3.5 tons.

| 148 LE | 149 LE | 150 QB



AL-KO



Mercedes-Benz

AL-KO





THE C-TOURER COMFORT

INDISPENSIBLE FOR COMFORT AND QUALITY

Having to keep tabs on the weight often means having to forego something. The c-tourer Comfort models are the right solution for anyone who does not want to forego anything with regard to comfort, and for whom registration within the 3.5 t weight class is not essential. After all, the Comfort models have some important added value: maximum individuality thanks to having the choice between three different layouts and between two worlds of

style and numerous worlds of living in the interior. Maximum comfort thanks to the high quality “smartline plus” furniture design, the ergonomic L-shaped lounge seating area and extra-large beds. Maximum storage space thanks to intelligent storage space solutions with a large double floor, large central through-loading storage compartment and extra-large scooter garage.



Comfort-related layouts with high payload reserves



Tremendous feeling of spaciousness, outstanding living comfort and a habitation width of 2.27 m

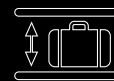

Unique double floor with large storage compartment



Large fresh and waste water reserves (150 l / 140 l)



Truma Combi 6 warm air storage heating technology

epic world of style as standard



Optional casablanca world of style





I 149 LE



I 149 LE

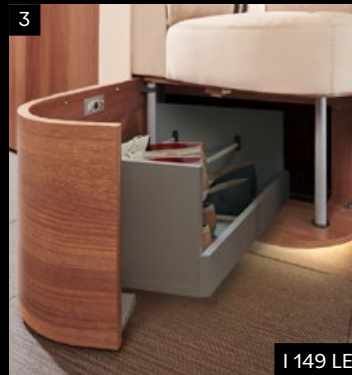

I 149 LE



I 148 LE



I 149 LE

LIVING | KITCHEN

- 1 Large L-shaped lounge seating area with lift-up side seat bench and 360° living area table
- 2 Smart 32" LED TV including "Quick-Up"* TV pull-out system behind side seat bench backrest
- 3 Swing-out shoe cabinet with holding system for up to four pairs of shoes
- 4 Corner kitchen with large work surface, six large drawers, separate waste bin in separate hygiene area, designer overhead storage cabinet with vertical waveform and elevated kitchen worktop for visual room partitioning and as an additional work surface | I 148 LE
- 5 Comfort corner kitchen with large, curved work surface, six large drawers, separate waste bin in separate hygiene area, designer overhead storage cabinet with vertical waveform and elevated kitchen worktop for visual room partitioning and as an additional work surface | I 149 LE, I 150 QB



BATHROOM

- 1 Combination bathroom with spacious round shower that is completely separable using a sliding door and a large mirrored storage cabinet | I 148 LE
- 2 Comfort luxury bathroom with spacious washroom and toilet room with spacious mirrored and wash table base unit and shower opposite with waterproof shower insert with same design as living area floor | I 149 LE, I 150 QB



CHANGING ROOM

1 Private changing room with partitioning from living/sleeping area; the solid wood sliding door in the sleeping area provides further room partitioning and therefore a completely separate changing room | I 148 LE, I 149 LE

2 Private changing room with partitioning from living/sleeping area; the pull-out TV wall and room partition in the sleeping area provides additional room partitioning and therefore a completely separate changing room | I 150 QB

3 Floor-to-ceiling wardrobe integrated in the changing room | I 148 LE

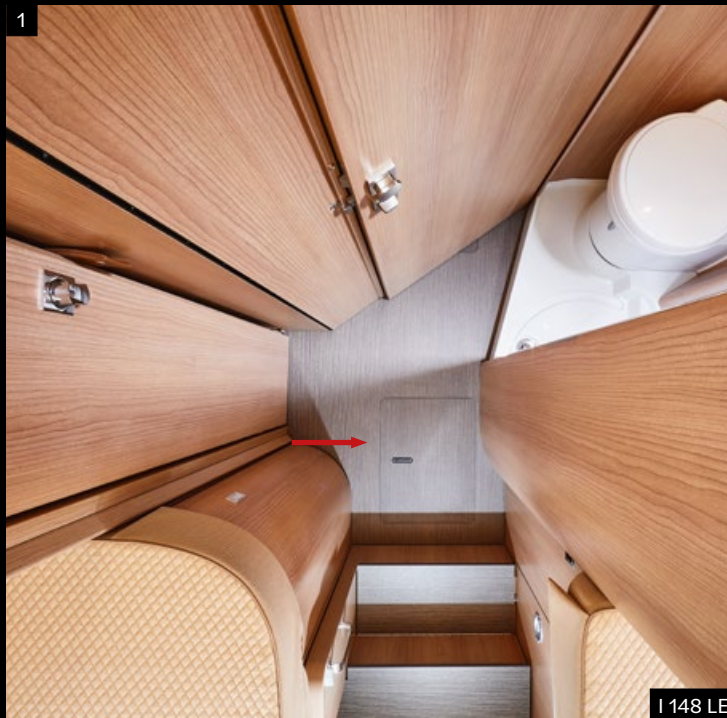

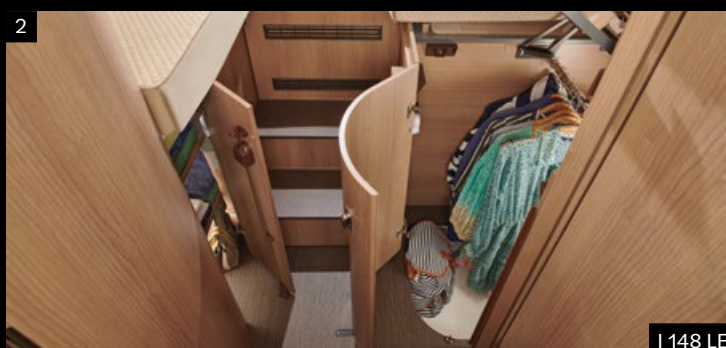

SLEEPING

- 1 Lengthways single beds with extra-large sleeping areas, adjustable head sections and comfort pull-out access steps | I 148 LE, I 149 LE
- 2 Wardrobes with large interior height beneath lengthways single beds, conveniently accessible from the front and above via the lift function | I 148 LE, I 149 LE
- 3 Large queen-size bed with extra-large sleeping area and adjustable head section | I 150 QB
- 4 Queen-size bed with wardrobe at both sides and two large drawers at the front | I 150 QB





STANDARD EQUIPMENT

- 1** XL habitation door “premium two 2.0” with widened 63 cm passage, secure double locking, extra-wide door window, pleated blackout blind and integrated insect screen roller blind
- 2** Convenient access to the garage at both sides thanks two large scooter garage doors at the driver and passenger sides
- 3** With a horizontally operated insulated pleated wind-screen blind, multi-functional, which acts as a sunblind, privacy screen and blackout blind with insulation at the same time
- 4** Unique double floor with large, heated storage compartment with usable height of up to 55.5 cm
- 5** Aguti driver’s cabin pilot seat with upholstered armrests, outstanding seat comfort, with multiple adjusting facilities
- 6** Integrated dashboard in the Cab area with leather-covered moulded surface and practical sideboard
- 7** Innovative light concept with ambient lighting
- 8** Ergonomically designed seat upholstery with multi-layer premium foam core and stylish front panel
- 9** Comfortably equipped kitchen with “Profi Gourmet” 3-ring hob with divided glass cover for additional storage area and work surface extension due to wall holder for sink cover

LAYOUTS

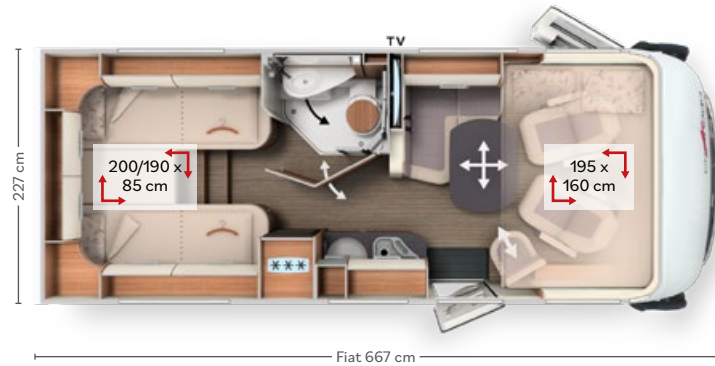

c-tourer Lightweight I 141 LE



Innovative layout with short vehicle length, specifically for the 3.5 t weight class

- + L-shaped lounge seating area with pull-out side seat and 360° living area table
- + Compact galley kitchen with six large drawers and separate waste bin in separate hygiene area
- + Space-saving Vario swivelling bathroom with separable changing room
- + Large lengthways single beds with pull-out lightweight access steps
- + Wardrobe with extra large interior height beneath the lengthways single beds
- + Scooter garage with extra large interior height

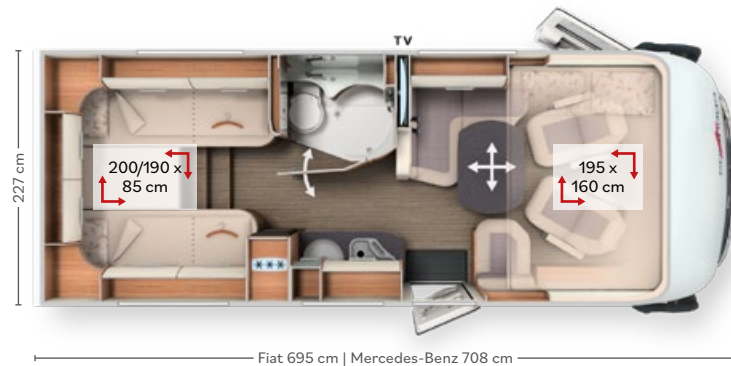

c-tourer Lightweight I 143 LE



All-rounder: lots of comfort, short vehicle length, light weight

- + L-shaped lounge seating area with lift-up side seat bench and 360° living area table
- + Compact galley kitchen with six large drawers and separate waste bin in separate hygiene area
- + Combined bathroom with separable changing room
- + Large lengthways single beds with pull-out lightweight access steps
- + Wardrobe with extra large interior height beneath the lengthways single beds
- + Scooter garage with extra large interior height

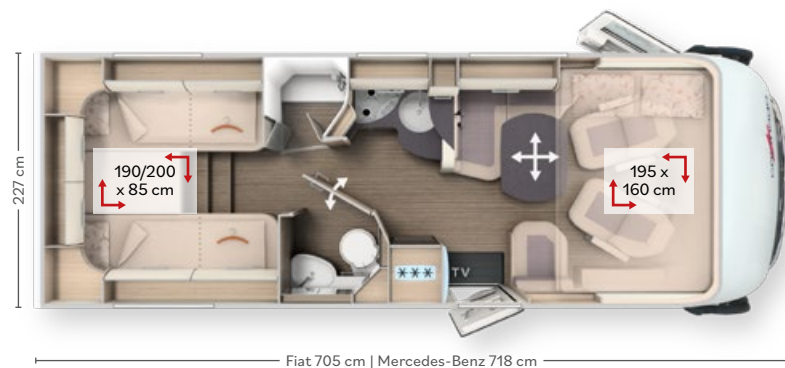

c-tourer Lightweight I 145 RB LE



Revolutionary! Unique! The new c-tourer I 145 RB LE

- + L-shaped lounge seating area with lift-up side seat bench and 360° living area table
- + Comfort corner kitchen with large work surface and elevated kitchen worktop for visual room partitioning and as additional storage area
- + Comfort luxury bathroom with separable changing room
- + Large lengthways single beds with access steps
- + Wardrobe with extra large interior height beneath the lengthways single beds
- + Scooter garage with extra large interior height





Further and detailed information can be found online at www.carthago.com

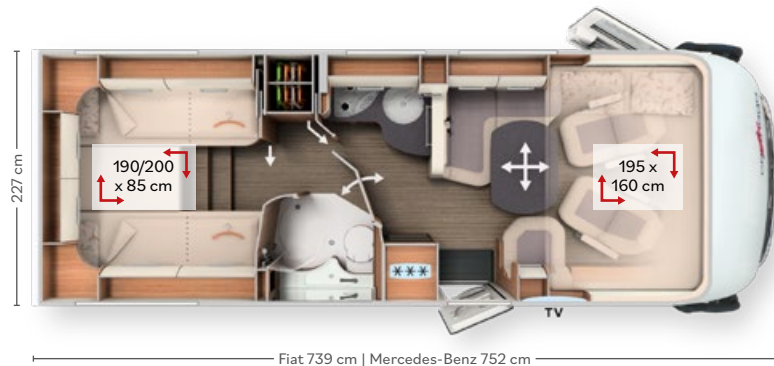

Fiat 739 cm | Mercedes-Benz 752 cm

c-tourer Comfort I 148 LE



- + Large L-shaped lounge seating area with wide, lift-up side seat bench and 360° living area table
- + Corner kitchen with large work surface and elevated kitchen worktop for visual room partitioning and as additional storage area
- + Combined bathroom with completely separable changing room
- + Large lengthways single beds with pull-out comfort access steps
- + Wardrobes with extra large interior height beneath the lengthways single beds and floor to ceiling wardrobe integrated in the changing room
- + Scooter garage with extra large interior height



AL-KO



Mercedes-Benz
AL-KO

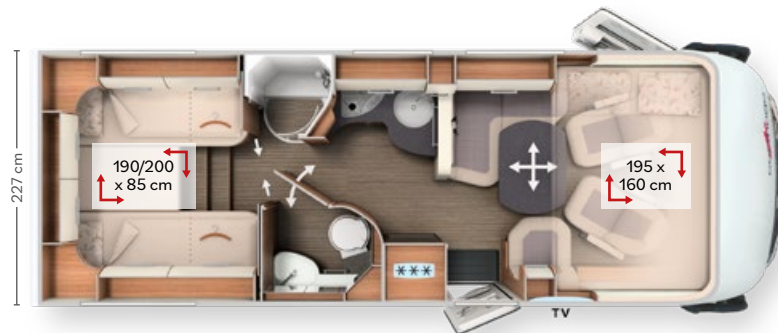

Fiat 752 cm | Mercedes-Benz 765 cm

c-tourer Comfort I 149 LE



- + Large L-shaped lounge seating area with wide, lift-up side seat bench and 360° living area table
- + Comfort corner kitchen with large, curved work surface and elevated kitchen worktop for visual room partitioning and as additional storage area
- + Comfort luxury bathroom with completely separable changing room
- + Large lengthways single beds with pull-out comfort access steps
- + Wardrobe with extra large interior height beneath the lengthways single beds
- + Scooter garage with extra large interior height



AL-KO



Mercedes-Benz
AL-KO

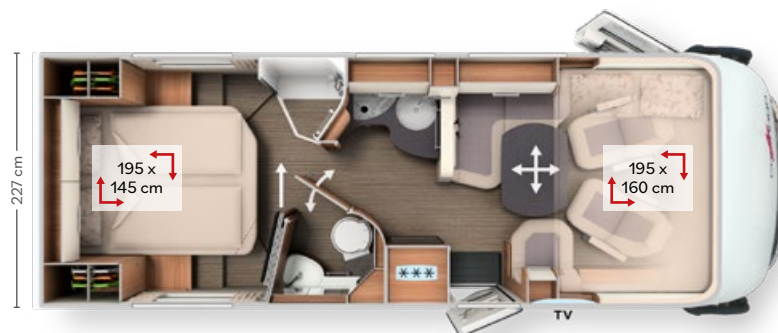

Fiat 748 cm | Mercedes-Benz 761 cm

c-tourer Comfort I 150 QB



- + Large L-shaped lounge seating area with wide, lift-up side seat bench and 360° living area table
- + Comfort corner kitchen with large, curved work surface and elevated kitchen worktop for visual room partitioning and as additional storage area
- + Comfort luxury bathroom with completely separable changing room
- + Large queen-size bed with convenient access and comfortable sleeping width
- + Queen-size bed with wardrobe at both sides and two drawers at the front
- + Scooter garage or Pedelec scooter garage*



AL-KO



Mercedes-Benz
AL-KO



Info



360°



chic c-line

THE FASCINATION OF
THE CARTHAGO LINER
PREMIUM CLASS

Elegance, comfort and extravagance

| 4.9 LE | | 4.9 LE L | | 5.0 OB | | 5.0 OB L



AL-KO



Mercedes-Benz

AL-KO



THE CHIC C-LINE

THE STEP UP TO THE CARTHAGO LINER PREMIUM CLASS

The chic c-line from Carthago defines itself by means of its elegance, comfort and outstanding practicality. The “exklusiveline” furniture design impresses with its flowing lines and rounded, exclusive furniture surfaces. The L-shaped lounge seating area has ergonomically designed upholstery, a wide side seat bench and a 360° living area table. The comfort corner kitchen has six large drawers, an elevated kitchen work surface with designer bar cabinet as a visual room divider and additional work surface, including a slide out storage cabinet. The comfort luxury

bathroom or XL bathroom provides maximum comfort, and has a completely separable changing room. The fixed beds are equipped with the point elastic Carawinx sleeping system. The double floor provides a large, heated storage compartment with a usable height of up to 70 cm, which is conveniently accessible from the outside and also the inside. Two basic vehicles, two worlds of style, numerous worlds of living and four different layouts are available. Discover the diversity of this model range and design the chic c-line which is a perfect match for you.



Comfort-oriented layouts up to a permissible gross vehicle weight of 4.5 t



Outstanding living comfort and impressive furniture design

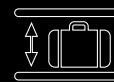

Unique double floor with large storage compartment



Large fresh and waste water reserves (170 l / 140 l)



Truma Combi 6 warm air storage heating technology or Alde warm water heating*

chic c-line

superior

THE EXCLUSIVE
VARIANT OF THE
CHIC C-LINE

| 4.9 LE superior | 4.9 LE L superior
| 5.0 QB superior | 5.0 QB L superior



AL-KO



Mercedes-Benz

AL-KO





THE CHIC C-LINE SUPERIOR

IN THE SOPHISTICATED YACHT STYLE WITH SUPERIOR EQUIPMENT

- 1 Extended “superior” exterior décor, “superior” designer radiator grille including horizontal chrome bars, “exklusive” designer front mask above wind-screen, “Liner” bonnet design and 16" aluminium wheels
- 2 Exclusive linea siena world of style with summer chestnut furniture décor and overhead cabinet doors with bicolor look in high gloss ivory
- 3 Kitchen worktop finish in solid and joint-free Corian



| 4.9 LE superior



| 4.9 LE superior



chic c-line

XL

THE XL VERSION OF
THE CHIC C-LINE

AL-KO low frame special
Carthago with 198 cm double axle
wide wheelbase rear axle

1 5.9 XL LE | 1 6.2 XL QB



AL-KO DA



Mercedes-Benz

AL-KO DA



Further and detailed information can be found online at www.carthago.com

THE CHIC C-LINE XL

WITH XXL COMFORT AND THE AL- KO DOUBLE AXLE

- 1 Spacious XL lounge seating area with long side sofa, including access to the storage compartment beneath
- 2 Floor-to-ceiling, slide-out storage cabinet integrated in round bathroom wall
- 3 XL bathroom with separate toilet room, open washing area and spacious round shower, changing room completely separable using solid wooden sliding doors, floor-to-ceiling wardrobe integrated in the changing room
- 4 Alde warm water heating and insulating double-glazed side windows / door windows in driver's cabin



linea moderna world of style as standard



Optional linea progressiva world of style





1 4.9 LE

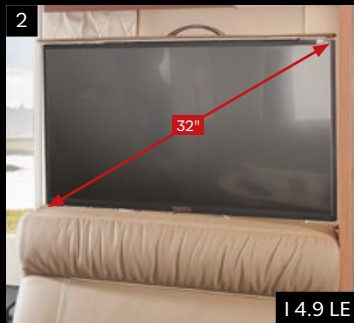

2 14.9 LE



3 14.9 LE



4 14.9 LE



5 14.9 LE



5 15.9 XL LE

LIVING | KITCHEN

- 1 Large L-shaped lounge seating area with wide side seat bench and 360° rectangular living area table with chrome piping
- 2 Smart 32" LED TV including "Quick up"* TV pull-out system behind side seat bench backrest | XL models: smart 40" LED TV including electric TV pull-out system*
- 3 Swivel-out shoe cabinet with holding system for up to four pairs of shoes
- 4 Comfort corner kitchen with elegantly curved work surface, six large drawers, separate waste bin in separate hygiene area, exclusive designer bar cabinet for six glasses and raised kitchen worktop for visual room partitioning and as an additional work surface
- 5 Slide out storage cabinet integrated in round bathroom wall | XL models: floor-to-ceiling slide out storage cabinet



BATHROOM

- 1 Comfort luxury bathroom with large washroom and toilet room with spacious mirrored and wash table base unit and shower opposite with waterproof shower insert with same design as living area floor | 4.9 LE, 4.9 LE L, 5.0 QB, 5.0 QB L
- 2 XL bathroom with open washing area with designer washbasin and XL round shower with waterproof shower insert with same design as living area floor | 5.9 XL LE, 6.2 XL QB
- 3 Separate toilet room with towel warmer, side window and additional legroom extension | 5.9 XL LE, 6.2 XL QB

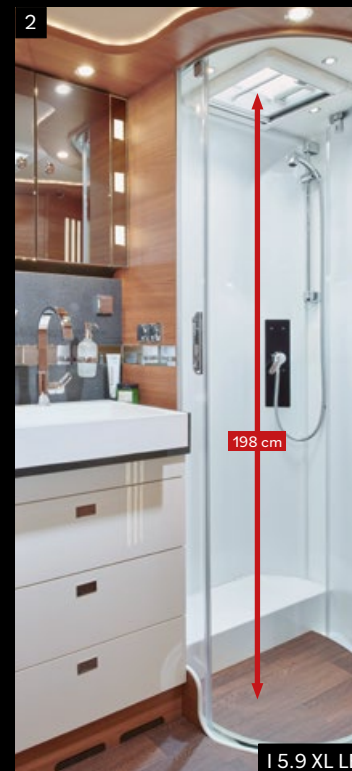

CHANGING ROOM

1 Completely separate changing room with lots of freedom of movement, with optional closed toilet room, room partitioning from living/sleeping area or both at the same time | I 4.9 LE, I 4.9 LE L, I 5.0 QB, I 5.0 QB L

2 Completely separate changing room with lots of freedom of movement, closed toilet room, room partitioning from living/sleeping area or both at the same time | I 5.9 XL LE, I 6.2 XL QB

3 Floor-to-ceiling wardrobe integrated in the changing room | I 4.9 LE L, I 5.0 QB L, I 5.9 XL LE, I 6.2 XL QB





SLEEPING

- 1 Lengthways single beds with adjustable head sections and pull-out comfort access steps | I 4.9 LE, I 4.9 LE L, I 5.9 XL LE
- 2 Wardrobes with large interior height beneath lengthways single beds, conveniently accessible from front and above via the lift function | I 4.9 LE, I 4.9 LE L, I 5.9 XL LE
- 3 Large queen-size bed with extra large sleeping area and adjustable head section | I 5.0 QB, I 5.0 QB L, I 6.2 XL QB
- 4 Two wardrobes at side of queen-size bed and two large drawers at the front | I 5.0 QB, I 5.0 QB L, I 6.2 XL QB

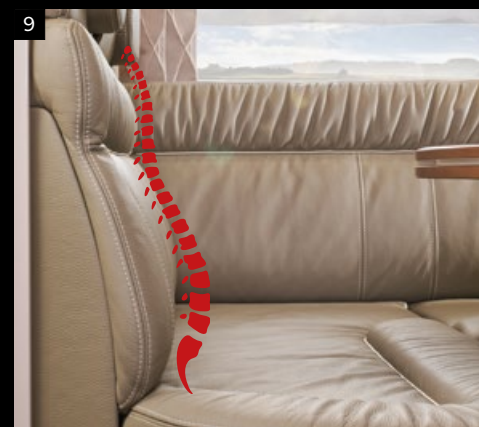



STANDARD EQUIPMENT

- 1** Carthago full LED front headlights with dipped beam and main beam including LED daytime driving lights for perfect illumination and excellent visibility
- 2** XL habitation door “premium two 2.0” with widened 63 cm passage, secure double locking, extra-wide door window, pleated blackout blind and integrated insect screen roller blind
- 3** “Coming home” function with remote control in main key for simultaneous activation of central locking and exterior lighting
- 4** Exterior hatches and doors with interior hinges – integrated flush in the body
- 5** Convenient access to the garage at both sides thanks to two large scooter garage doors at the driver and passenger sides
- 6** Stylish GRP bus rear with separate rear bumper, and rear lights with modern dynamic LED indicators
- 7** Aguti driver’s cabin pilot seat with outstanding seat comfort, two armrests and multiple adjusting facilities
- 8** Innovative light concept with ambient lighting, including continuously variable dimming function
- 9** Ergonomically shaped seat upholstery with multi-layer premium foam core and stylish front panel

LAYOUTS

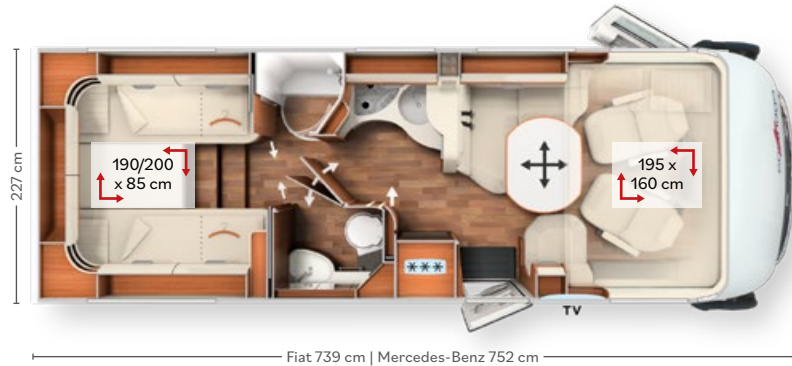

chic c-line | 4.9 LE | | 4.9 LE superior

- + L-shaped lounge seating area with wide side seat bench and 360° rectangular living area table
- + Large luxury corner kitchen with curved worktop and slide out storage cabinet
- + Comfort luxury bathroom with separable changing room
- + Large lengthways single beds with pull-out comfort access steps
- + Wardrobe with extra large interior height beneath the lengthways single beds
- + Scooter garage with extra large interior height



AL-KO



Mercedes-Benz
AL-KO

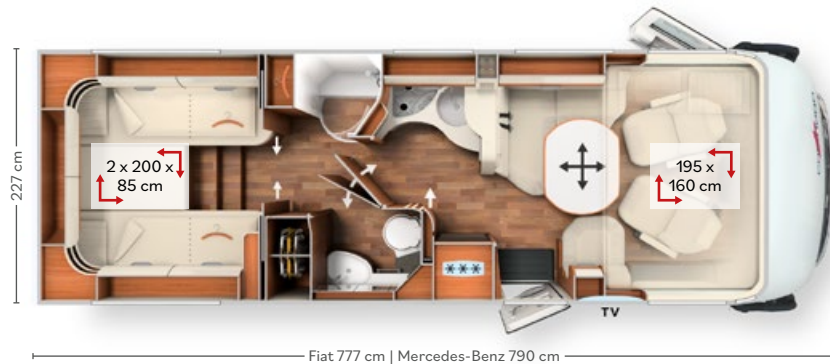

chic c-line | 4.9 LE L | | 4.9 LE L superior

- + L-shaped lounge seating area with wide side seat bench and 360° rectangular living area table
- + Large luxury corner kitchen with curved worktop and slide out storage cabinet
- + Comfort luxury bathroom with completely separable changing room
- + Large lengthways single beds with pull-out comfort access steps
- + Wardrobes with extra large interior height beneath the lengthways single beds and floor-to-ceiling wardrobe integrated in the changing room
- + Scooter garage with extra large interior height



AL-KO



Mercedes-Benz
AL-KO

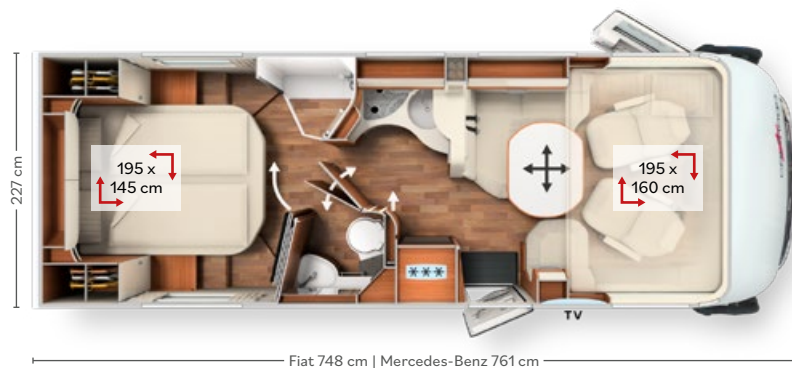

chic c-line | 5.0 QB | | 5.0 QB superior

- + L-shaped lounge seating area with wide side seat bench and 360° rectangular living area table
- + Large luxury corner kitchen with curved worktop and slide out storage cabinet
- + Comfort luxury bathroom with completely separable changing room
- + Large queen-size bed with convenient access and comfortable sleeping width
- + Queen-size bed with wardrobe at both sides and two drawers at the front
- + Scooter garage or Pedelec scooter garage*



AL-KO



Mercedes-Benz
AL-KO



Further and detailed information can be found online at www.carthago.com

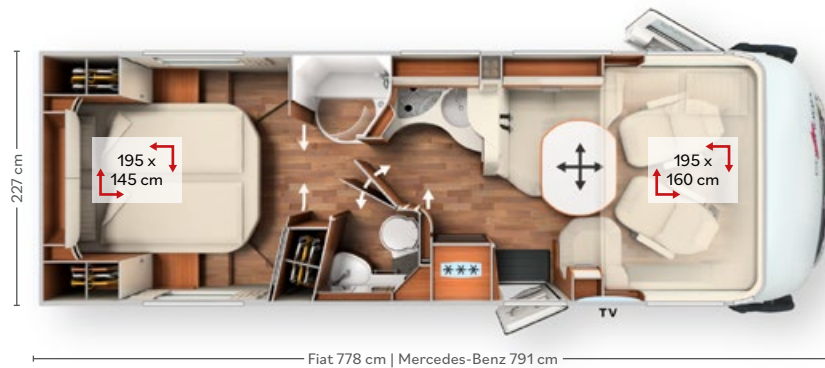

chic c-line | 5.0 QB L | | 5.0 QB L superior

- + L-shaped lounge seating area with wide side seat bench and 360° rectangular living area table
- + Large luxury corner kitchen with curved worktop and slide out storage cabinet
- + Comfort luxury bathroom with completely separable changing room
- + Large queen-size bed with convenient access and comfortable sleeping width
- + Queen-size bed with wardrobe at both sides and two large drawers at the front and floor-to-ceiling wardrobe integrated in the changing room
- + Scooter garage or Pedelec scooter garage*



AL-KO



Mercedes-Benz
AL-KO



chic c-line | 5.9 XL LE

- + Spacious XL lounge seating area with long side sofa and 360° rectangular living area table
- + Large luxury corner kitchen with curved worktop and floor-to-ceiling slide out storage cabinet
- + XL bathroom with completely separable changing room
- + Large lengthways single beds with pull-out comfort access steps
- + Wardrobes with extra large interior height beneath the lengthways single beds and floor-to-ceiling wardrobe integrated in the changing room
- + Scooter garage with extra large interior height



AL-KO



Mercedes-Benz
AL-KO



chic c-line | 6.2 XL QB

- + Spacious XL lounge seating area with long side sofa and 360° rectangular living area table
- + Large luxury corner kitchen with curved worktop and floor-to-ceiling slide out storage cabinet
- + XL bathroom with completely separable changing room
- + Large queen-size bed with convenient access and comfortable sleeping width
- + Queen-size bed with wardrobe at both sides and two large drawers at the front and floor-to-ceiling wardrobe integrated in the changing room
- + Scooter garage or Pedelec scooter garage*



AL-KO



Mercedes-Benz
AL-KO



Info



360°

chic e-line

THE JEWEL IN THE
CROWN OF THE
CARTHAGO LINER CLASS

More comfort, more self-sufficiency,
more independence

I 50 LE | I 51 QB



AL-KO EA/DA



Mercedes-Benz

AL-KO EA/DA





THE CHIC E-LINE

IMPRESSIVE ELEGANCE

The chic e-line impresses with its unique “emotionale” furniture design, the two level room concept and the tremendous living area height of 211 cm. The self-sufficiency champion is more exclusive and comfortable than ever before. The large round seating area with luxury living area table and wide side seat bench invites you to spend time there. The comfort corner kitchen has a pull-out kitchen work surface with worktop extension. The comfort luxury bathroom with completely separable changing room creates sufficient room and privacy for undisturbed freshening

up. The double floor provides a large, heated storage compartment which is conveniently accessible from the outside and also the inside. Two different layouts, two basic vehicles, two worlds of style and numerous worlds of living are available for fulfilling your individual requirements. The chic e-line leaves nothing to be desired, and impresses with its appealing design and outstanding degree of comfort. Discover the variety and design your chic e-line completely in accordance with your requirements.



Comfort-related layouts and high payload reserves



Two-level room concept with extra-high living area headroom of 211 cm

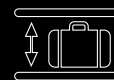

Unique double floor with large storage compartment



Large fresh and waste water reserves (235 l / 185 l)



Alde warm water central heating and Carthago driver's cabin thermal concept



Info



360°

chic s-plus

THE POWERHOUSE
OF THE CARTHAGO
LINER CLASS

On the Iveco Daily 5.6 t / 6.7 t with high-
traction rear-wheel drive / dual wheels

I 50 LE

IVECO
DAILY
5.6t/6.7t





Further and detailed information can be found online at www.carthago.com

THE CHIC S-PLUS

OUTSTANDING COMFORT AND PURE ELEGANCE

The chic s-plus impresses with its exclusive and innovative design and its generous living area height of 211 cm. As well as having abundant payload reserves, the robust Iveco Daily basic vehicle can also handle heavy towing loads of up to 3.5 t. The 3.0 l engine with torque of 470 Nm and up to 207 HP is extremely powerful. The chic s-plus impresses in the interior with its exclusive “emotionale” furniture design and two level room concept. The large round seating area with luxury living area table and comfort corner kitchen with pull-out kitchen work surface round off the interior

perfectly. You can freshen up without being disturbed in the comfort luxury bathroom including completely separable changing room, with lots of room and privacy. The double floor provides a large, heated storage compartment which is conveniently accessible from the outside and also the inside. You can choose between two worlds of style and numerous worlds of living to fulfil your individual requirements. Discover the extraordinary driving experience, the top class comfort and the unmistakable Liner gene of the chic s-plus.

**IVECO
DAILY**



Ladder frame chassis with high-traction rear-wheel drive and dual wheels

Comfort-related layouts and high payload reserves



Two-level room concept with extra-high living area headroom of 211 cm

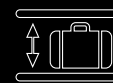

Unique double floor with large storage compartment



Large fresh and waste water reserves (235 l / 200 l)



Alde warm water central heating and Carthago driver's cabin thermal concept



chic e-line XL

chic s-plus XL

THE XL CROWN JEWEL OF
THE CARTHAGO LINER CLASS

AL-KO low frame special Carthago with 198 cm
wide wheelbase double axle rear axle

| 61 XL LE | | 64 XL QB



AL-KO DA



Mercedes-Benz

AL-KO DA

IVECO
DAILY

6.7t



THE CHIC E-LINE XL & THE CHIC S-PLUS XL

WITH MAXIMUM PAYLOAD RESERVES

- 1** Fiat Ducato 40 heavy DA or Mercedes-Benz Sprinter 415 CDI DA, AL-KO low frame special Carthago and permissible gross weight of up to 5.5 t | chic e-line XL
- 2** Iveco Daily, ladder frame chassis with high-traction rear-wheel drive and dual wheels with permissible gross weight of up to 6.7 t | chic s-plus XL
- 3** Spacious XL round seating area with long, pull-out side sofa, including access to the storage compartment below
- 4** XL bathroom with separate toilet room, open washing area and spacious round shower, room partitioning from living and sleeping areas via solid wooden sliding doors.



linea chiara world of style as standard



Optional linea nobile world of style





I 50 LE

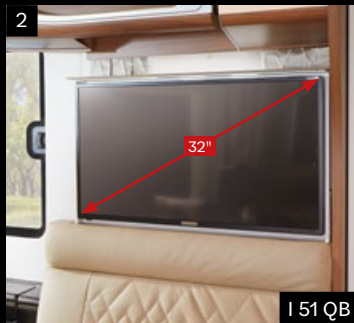

I 51 QB

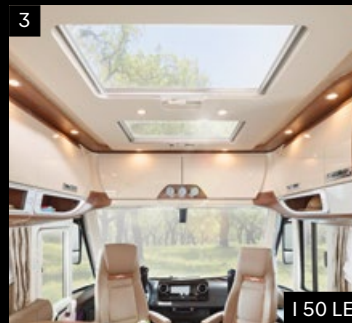

I 50 LE



I 50 LE



I 50 LE

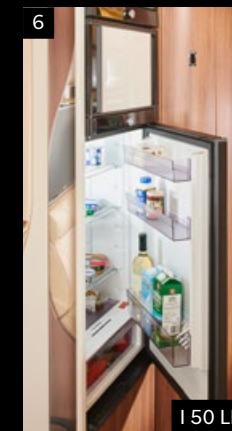

I 50 LE

LIVING | KITCHEN

- 1 Spacious round seating area and luxury living room table with real wood round profile and chrome piping
- 2 Smart 32" LED TV including "Quick up"* TV pull-out system behind side seat bench backrest | XL models: smart 40" LED TV including electric TV pull-out system*
- 3 "Sky Dream Comfort" with all-round overhead storage cabinets and two large panoramic skylights above the round seating area and the driver's cabin instead of the drop-down bed*
- 4 Comfort corner kitchen with elegantly curved worktop, pull-out kitchen work surface as worktop extension and exclusive designer bar cabinet for six glasses, with central locking
- 5 Slide-out storage cabinet integrated in round bathroom wall | floor-to-ceiling in XL models
- 6 153 l fridge with door that opens at both sides and separate freezer compartment



BATHROOM

- 1 Comfort luxury bathroom and toilet room with large, mirrored cabinet and wash stand base unit with plenty of storage space | I 50 LE, I 51 QB
- 2 Spa rain shower with roof light above, shower corner pillar with dark granite look, indirectly illuminated corner pillar, and shower walls with marble design | I 50 LE, I 51 QB
- 3 XL bathroom with open washing area with designer washbasin and XL round shower with luxurious spa rain shower, shower tray and shower corner pillar with dark granite look and shower walls in marble design | I 61 XL LE, I 64 XL QB
- 4 Separate toilet with towel warmer, side window and additional legroom extension | I 61 XL LE, I 64 XL QB

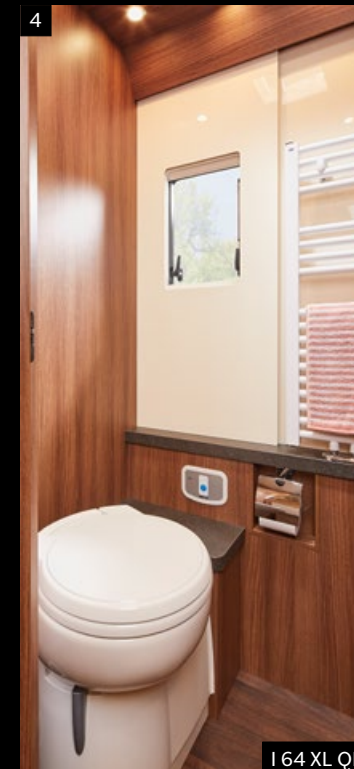
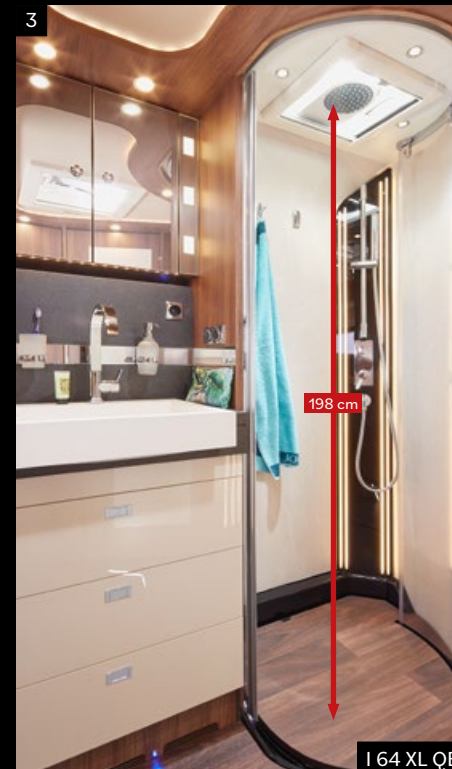
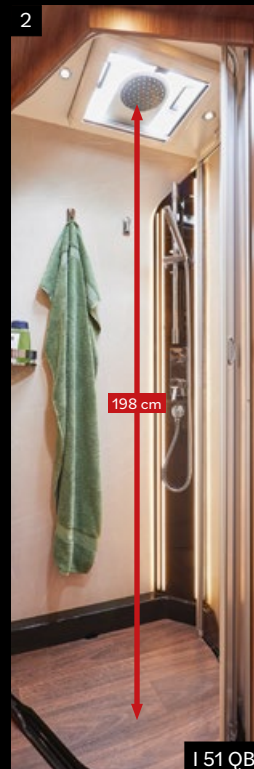

CHANGING ROOM

1 Completely separate changing room with a considerable amount of freedom of movement, with optional closed toilet room, room partitioning from living and sleeping area or both at the same time | I 50 LE, I 51 QB

2 Completely separate changing room with a considerable amount of freedom of movement, closed toilet room, room partitioning from living and sleeping area or both at the same time | I 61 XL LE, I 64 XL QB

3 Floor-to-ceiling wardrobe integrated in the changing room | I 50 LE, I 61 XL LE, I 64 XL QB





SLEEPING

- 1 Lengthways single beds with adjustable head sections and pull-out comfort access steps | I 50 LE, I 61 XL LE
- 2 Wardrobes with large interior height beneath lengthways single beds, conveniently accessible from front and above via the lift function | I 50 LE, I 61 XL LE
- 3 Extra large queen-size bed in 200 cm king-size format with adjustable head section | I 51 QB, I 64 XL QB
- 4 Queen-size bed with wardrobe at both sides and two large drawers at the front | I 51 QB, I 64 XL QB

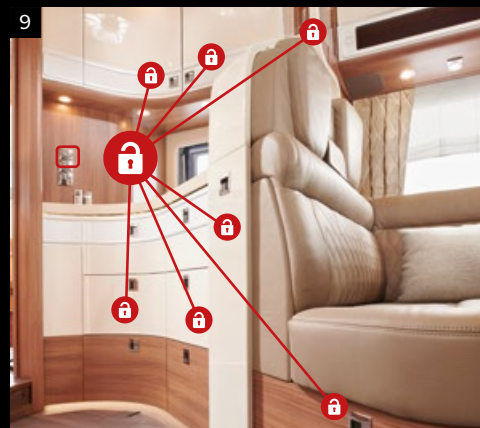



STANDARD EQUIPMENT

- 1** Carthago full LED front headlights with dipped and main beam and daytime driving lights with LED fibre optics – fatigue-free driving even at dusk and during the night due to optimum road surface illumination
- 2** Coach windscreen wiper system wiping in opposite directions with extended wiping area and field of view | chic s-plus
- 3** XL habitation door “Safetylux” with extra-strong and stable door, wider passage size of 63 cm, large door window, secure double locking, three high-stability parallelogram steel hinges, integrated pleated blackout blind and insect screen roller blind
- 4** “coming home” function with remote control in main key for simultaneous activation of central locking and exterior lighting
- 5** Stylish GRP bus rear with separate rear bumper, and rear lights with modern dynamic LED indicators
- 6** Passengers door with security double locking
- 7** Electric pleated windscreen blind with individually programmable privacy and sun visor function
- 8** Innovative light concept with ambient lighting, including continuously variable dimming function
- 9** Electric central locking in kitchen area including kitchen work surface, kitchen drawers, overhead kitchen cabinets, bar cabinet, and shoe cabinet

LAYOUTS



chic e-line I 50 LE | chic s-plus I 50 LE

- + Large round seating area with luxury living area table and wide side seat bench
- + Large luxury corner kitchen with curved worktop and slide out storage cabinet
- + Comfort luxury bathroom with completely separable changing room
- + Large lengthways single beds with pull-out comfort access steps
- + Wardrobes with extra large interior height beneath the lengthways single beds and floor-to-ceiling wardrobe integrated in the changing room
- + Scooter garage with extra large interior height



AL-KO EA/DA



Mercedes-Benz
AL-KO EA/DA



IVECO
DAILY
5.6 t / 6.7 t

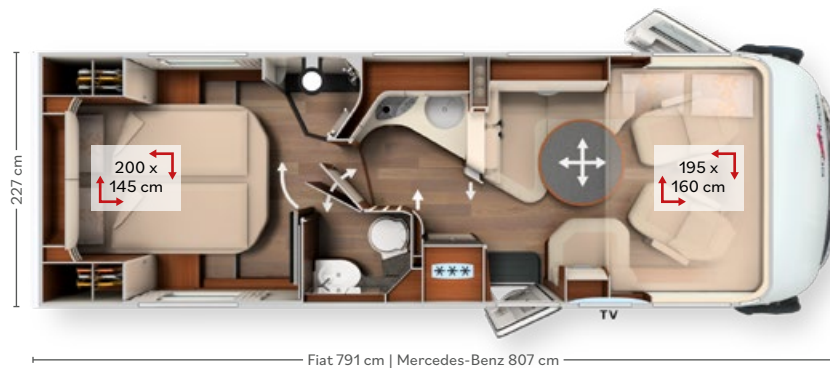

chic e-line I 51 QB

- + Large round seating area with luxury living area table and wide side seat bench
- + Large luxury corner kitchen with curved worktop and slide out storage cabinet
- + Comfort luxury bathroom with completely separable changing room
- + Extra-large queen-size bed in 200 cm king-size format
- + Queen-size bed with wardrobe at both sides and two drawers at the front
- + Scooter garage or Pedelec scooter garage*



AL-KO EA/DA



Mercedes-Benz
AL-KO EA/DA



Further and detailed information can be found online at www.carthago.com

chic e-line | 61 XL LE | chic s-plus | 61 XL LE



- + Large XL round seating area luxury living area table with long side sofa
- + Large luxury corner kitchen with curved worktop and floor-to-ceiling slide out storage cabinet
- + XL bathroom with completely separable changing room
- + Large lengthways single beds with pull-out comfort access steps
- + Wardrobes with extra large interior height beneath the lengthways single beds and floor-to-ceiling wardrobe integrated in the changing room
- + Scooter garage with extra large interior height



AL-KO DA



Mercedes-Benz
AL-KO DA



6.7 t

chic e-line | 64 XL QB | chic s-plus | 64 XL QB



- + Large XL round seating area luxury living area table with long side sofa
- + Large luxury corner kitchen with curved worktop and floor-to-ceiling slide out storage cabinet
- + XL bathroom with completely separable changing room
- + Extra-large queen-size bed in 200 cm king-size format
- + Queen-size bed with wardrobe at both sides and two large drawers at the front and floor-to-ceiling wardrobe integrated in the changing room
- + Scooter garage or Pedelec scooter garage*



AL-KO DA



Mercedes-Benz
AL-KO DA



6.7 t



Info



360°



Liner-for-two

ROUND REAR LOUNGE
SEATING AREA

With electrically extendible TV lounge
and unique 4-room concept

I 53 | I 53 L



AL-KO EA/DA

**IVECO
DAILY**

5.6t/6.7t



Further and detailed information can be found online at www.carthago.com

THE LINER-FOR-TWO

THE UNIQUE DEFINITION OF THE MOTORHOME WITH REAR SEATING AREA

The liner-for-two provides excellent comfort and unique sophistication with the unique 4-room concept. In the front area there are electrically lowerable lengthways single beds with a spacious, continuous sleeping area. In the rear area of the vehicle you will find an exclusive round lounge seating area. The extra-wide kitchen with the elegantly curved kitchen worktop and comfort luxury bathroom rounds off the luxurious ambience. The liner-for-two also impresses with a large double floor which provides a tremendous

amount of storage space. The liner-for-two combines all of these exclusive advantages from a vehicle length of just 7.83 m. You have the choice between the Fiat Ducato AL-KO with a single or double axle or the Iveco Daily with a permissible gross weight of up to 5.8 t / 6.7 t. Put your dream model together from two layouts, two different basic vehicles and numerous worlds of living, and personalise your motorhome in accordance with your ideas.



Comfort-related layouts and high payload reserves



Round rear lounge seating area and unique 4-room concept

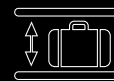

Unique double floor with large storage compartment



Large fresh and waste water reserves (210 l / 155 l)



Alde warm water central heating and Carthago driver's cabin thermal concept

siena bicolor world of style as standard







LIVING | KITCHEN

- 1 Round rear lounge seating area with plenty of room, electrically extendible TV lounge* and a unique, comfortable TV viewing position for two persons
- 2 Large luxury living room table with exclusive real wood profile, movable in two directions
- 3 Raised kitchen work surface with vertical waveform for visual room partitioning with a large storage cabinet and sliding door running in the opposite direction
- 4 Large kitchen with curved kitchen worktop with Corian anti-drip edge and six large drawers



BATHROOM

- 1 Comfort luxury bathroom with large washroom, spacious wash stand base unit, washing basket and large mirrored cabinet
- 2 Wellness spa rain shower opposite with marble design with shower tray and indirectly illuminated shower corner pillar with dark granite look and waterproof shower insert in same design as living area floor
- 3 Luxury bathroom door in high gloss ivory with horizontally integrated chrome inlays





CHANGING ROOM

- 1 Completely separate changing room with a considerable amount of freedom of movement, room partitioning from living and sleeping area or both at the same time
- 2 Floor-to-ceiling wardrobe with two clothes rails and shelf, integrated in the changing room; Wardrobe door in high gloss ivory with horizontally integrated chrome inlays



SLEEPING

- 1 Electrically lowerable lengthways single beds with spacious, continuous sleeping area and ease of access thanks to low-level bed and pull-out access steps
- 2 Sliding doors beneath drop-down bed to prevent the ingress of cold from the driver's cabin
- 3 The lowerable lengthways single beds can be wonderfully integrated in the living area during the day



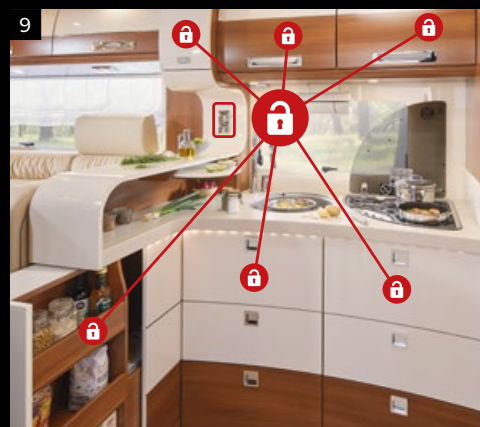



STANDARD EQUIPMENT

- 1** Full LED headlights including radiator grille with double chromium bars; Additional with Iveco Daily: coach windscreen wiper system, with wipers moving in opposing directions
- 2** XL habitation door “Safetylux” with extra-strong and stable door, widened passage size of 63 cm, large door window, secure double locking, three high-stability parallelogram steel hinges, integrated pleated blackout blind and insect screen roller blind
- 3** “Coming home” function with remote control in main key for simultaneous activation of central locking and exterior lighting
- 4** Scooter garage with external shower (hot and cold water) and scooter garage hatches each with two gas pressure dampers and pulling loops, can be swivelled upwards
- 5** Stylish GRP bus rear with separate rear bumper and rear lights with modern dynamic LED indicators
- 6** Passengers door with security double locking
- 7** Carthago driver's cab thermal concept with insulated double glazing in the driver's cabin, including a convective package beneath the driver's seat and additional heating of the dashboard surface
- 8** Innovative light concept with ambient lighting including continuously adjustable dimming function
- 9** Electric central locking in the kitchen area including the kitchen work surface, drawers and overhead storage compartments



OFFICE AND TV ROOM PACKAGE*

THE PERFECT WORKPLACE FOR ON THE ROAD

- + Rotating driver and passenger seats
- + Pull-out table top from sideboard
- + Additional USB and 230 V sockets
- + Smart 24" LED TV including TV holder with height adjusting facility

LAYOUTS



Further and detailed information can be found online at www.carthago.com



liner-for-two | 53

Unique layout design with exclusive round rear lounge seating area, and innovative 4-room concept

- + Electrically lowerable lengthways single beds with large sleeping dimensions and continuous sleeping area
- + Comfort luxury bathroom with completely separable changing room
- + Floor-to-ceiling wardrobe with two clothes rails and shelf integrated in the changing room
- + Large, curved kitchen with elegant kitchen work surface in vertical waveform
- + Pedelec scooter garage



AL-KO



5.6 t



liner-for-two | 53 L

Extra-large feeling of spaciousness in the round rear lounge seating area with additional storage area, including access to additional storage compartment and two illuminated glass display cabinets for six wine glasses and six drinking glasses

- + Electrically lowerable lengthways single beds with large sleeping dimensions and continuous sleeping area
- + Comfort luxury bathroom with completely separable changing room
- + Floor-to-ceiling wardrobe with two clothes rails and shelf integrated in the changing room
- + Large, curved kitchen with elegant kitchen work surface in vertical waveform
- + Scooter garage with extra-large interior height



AL-KO DA



6.7 t



Changes may occur during the model year after the editorial deadline for this printed document in July 2023. The manufacturer reserves the right to make structural and design changes that become necessary, provided they are in the interest of technical progress and are reasonable for the customer, plus changes to equipment, differences in colour combinations or individual colour shades, material quality differences and changes to the scope of delivery on the part of the manufacturer. This also applies to colour differences on basic vehicles, insofar as they are a result of changes made by the basic vehicle manufacturer. Please consult your dealer for detailed advice concerning the status of the current product or series.

The information about the scope of delivery, appearance, performance, dimensions and weights of the vehicles (differences within the scope of the factory tolerances ($\pm 5\%$ max.) are possible and permissible) corresponds to the state of knowledge at the time of going to print. Please be aware that some of the vehicles are depicted with special equipment for which an additional charge applies. In some cases they are shown with equipment features that do not correspond to the series production version and are also not available as special equipment. The decoration depicted in the catalogue is not a constituent of the scope of delivery. More technical information can be found in the price list.

Prior written consent from Carthago Reisemobilbau GmbH is required for the reprinting of this publication or extracts thereof. The information in this publication is compliant with the German StVO and StVZO (road traffic and road traffic licensing regulations). Mistakes, printing errors and translation errors excepted. All information is based on the characteristics of the German market.

Printed in Germany.

© Carthago Reisemobilbau GmbH
88326 Aulendorf
Tel. +49 7525 9200-0